

Directions

Viewings

Viewings by arrangement only. Call 02085042440 to make an appointment.

EPC Rating

| Energy Efficiency Rating | | |
|---|---------|-----------|
| | Current | Potential |
| Very energy efficient - lower running costs | | |
| (92 plus) A | | |
| (81-91) B | | |
| (69-80) C | | |
| (55-68) D | | |
| (39-54) E | | |
| (21-38) F | | |
| (1-20) G | | |
| Not energy efficient - higher running costs | | |
| England & Wales | | |
| EU Directive 2002/91/EC | | |

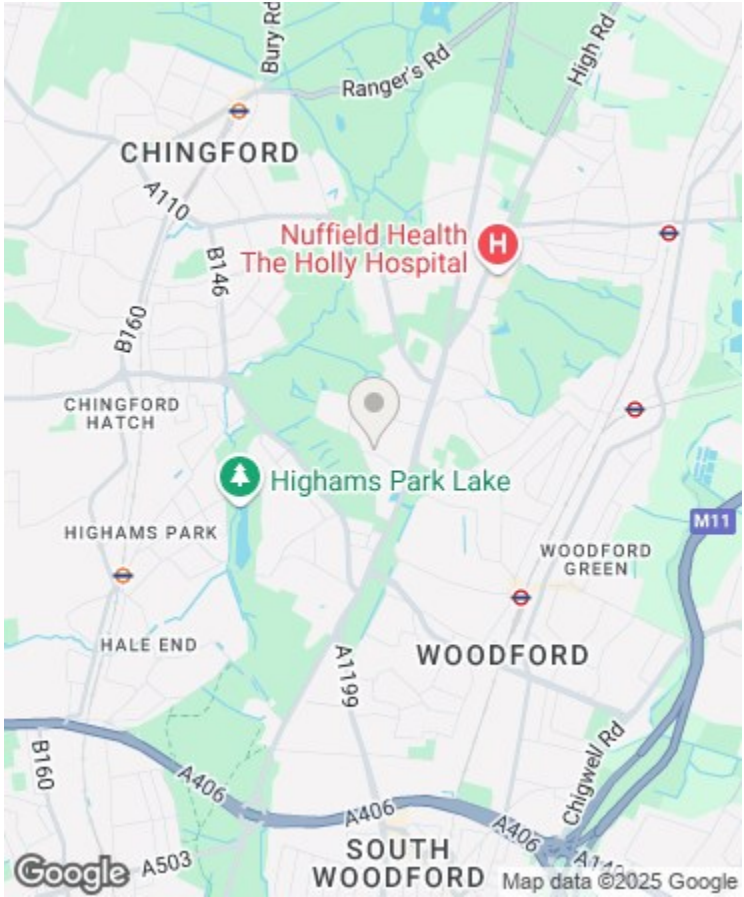

Ground Floor

Approx. 35.6 sq. metres (383.5 sq. feet)

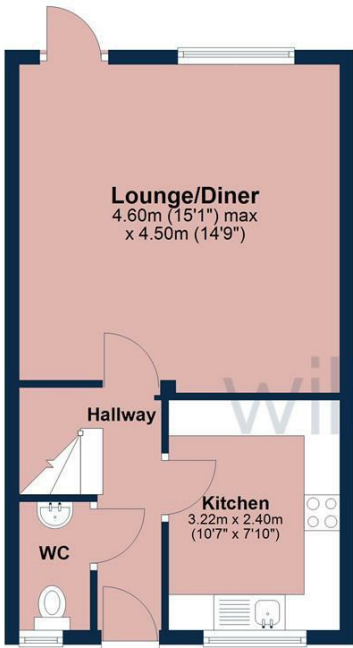

First Floor

Approx. 35.3 sq. metres (379.9 sq. feet)

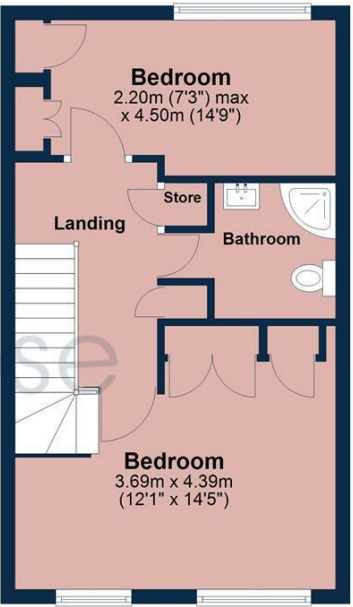

Total area: approx. 70.9 sq. metres (763.4 sq. feet)

All measurements have been taken as a guide to prospective buyers only and are not precise. This plan is for illustrative purposes only and no responsibility for any error, omission or misstatement. The services, systems and appliances shown have not been tested and no guarantee as to their operability or efficiency can be given. Measurements may have been taken from the widest area and may include wardrobe/cupboard space. No guarantee is given to any measurements including total areas. Buyers are advised to take their own measurements.

© @modephotouk | www.modephoto.co.uk
Plan produced using PlanUp.

Jacklin Green



38 Jacklin Green, Woodford Green, IG8 0TY

£1,900 Per Month

- Two bedroom House
- Lounge overlooking rear garden
- Off Street parking
- Sought after development
- Downstairs Cloakroom
- Modern Kitchen and Bathroom
- Close to Epping Forest
- Close to popular Schools
- Well-Proportioned bedrooms
- Lots of natural light

38 Jacklin Green, Woodford Green IG8 0TY

Situated in the desirable area of Jacklin Green, Woodford Green, this charming mid-terrace house offers a balanced convenient and calm lifestyle. Located moments away from Epping Forest and multiple popular schools.

Tucked away in the sought-after Jacklin Green area of Woodford Green, this charming two-bedroom home effortlessly blends modern comforts with a peaceful, natural setting. Ideal for professionals, couples, or small families, it offers a lifestyle that balances convenience with calm.

Step into a spacious and light-filled reception room —perfect for unwinding after a busy day or entertaining guests in a relaxed atmosphere. The contemporary kitchen is both stylish and functional, designed to meet the needs of any home cook or culinary enthusiast.

Upstairs, two generously sized bedrooms provide comfortable retreats, complemented by a well-appointed bathroom that offers both practicality and comfort.

Outside, a private garden invites you to enjoy quiet mornings, alfresco dining, or a bit of weekend gardening. The property also benefits from off-street parking, adding to your convenience and peace of mind.

Nature lovers will appreciate the close proximity to nearby woodlands and green spaces, ideal for scenic walks, bike rides, or simply soaking in the outdoors. Despite its tranquil setting, the home remains well-connected to local amenities, schools, and transport links—making daily life easy and stress-free.

If you’re looking for a harmonious blend of modern living and natural beauty, this delightful home in Jacklin Green could be your perfect match.

 2

 1

 1



Council Tax Band: D

